

- 1 MATERIAL: CONNECTOR-NYLON UL94V-2 (GREEN).  
 CONTACTS-0.30 [.012] THICK COPPER ALLOY  
 BRIGHT TIN-LEAD 0.00203 [.000080] MINIMUM THICK FOR CONTACTS  
 641537-2 THRU 641537-3,  
 MATTE WHISKER MITIGATED TIN PLATE 0.00203 [.000080] MINIMUM THICK OVER  
 NICKEL UNDERPLATE FOR CONTACTS 3-641537-2 THRU 3-641537-3.
- 2. CONTACTS ACCEPT 28 AWG WIRE WITH 1.52 [.060] MAXIMUM INSULATION DIAMETER.
- 3. CONTACTS MUST ACCEPT 0.36-0.51 [.014-.020] SQUARE OR ROUND POST AND  
 REMAINED LOCKED IN POSITION.
- 4 IDENTIFICATION NUMBER FOR LAST CIRCUIT MAY NOT APPEAR ON ALL ASSEMBLIES.
- 5. DIMENSIONS IN BRACKETS ARE IN INCHES.
- 6. HOUSING FEATURES ARE: CLOSED END WITH LOCKING RAMP & LED CONTACT.

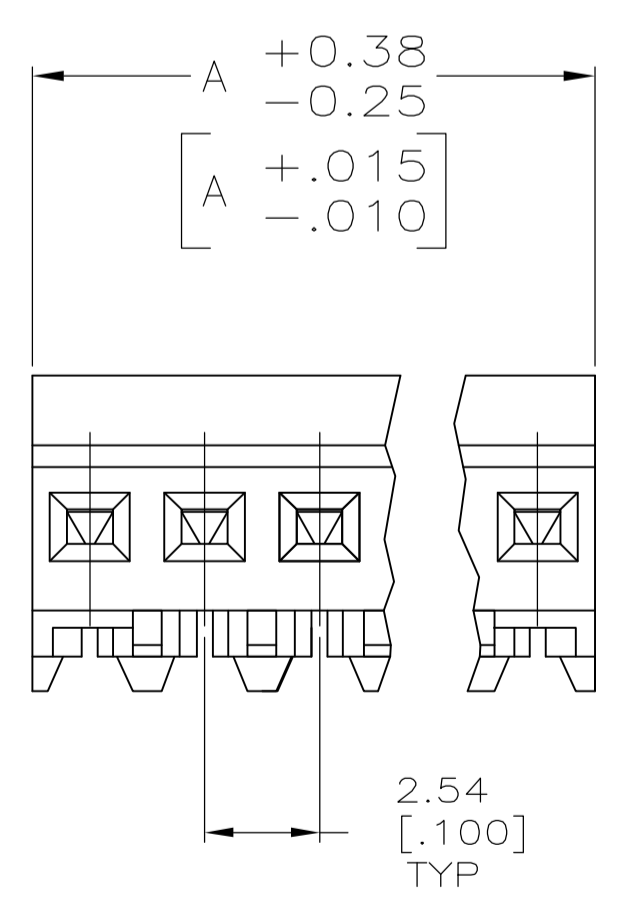
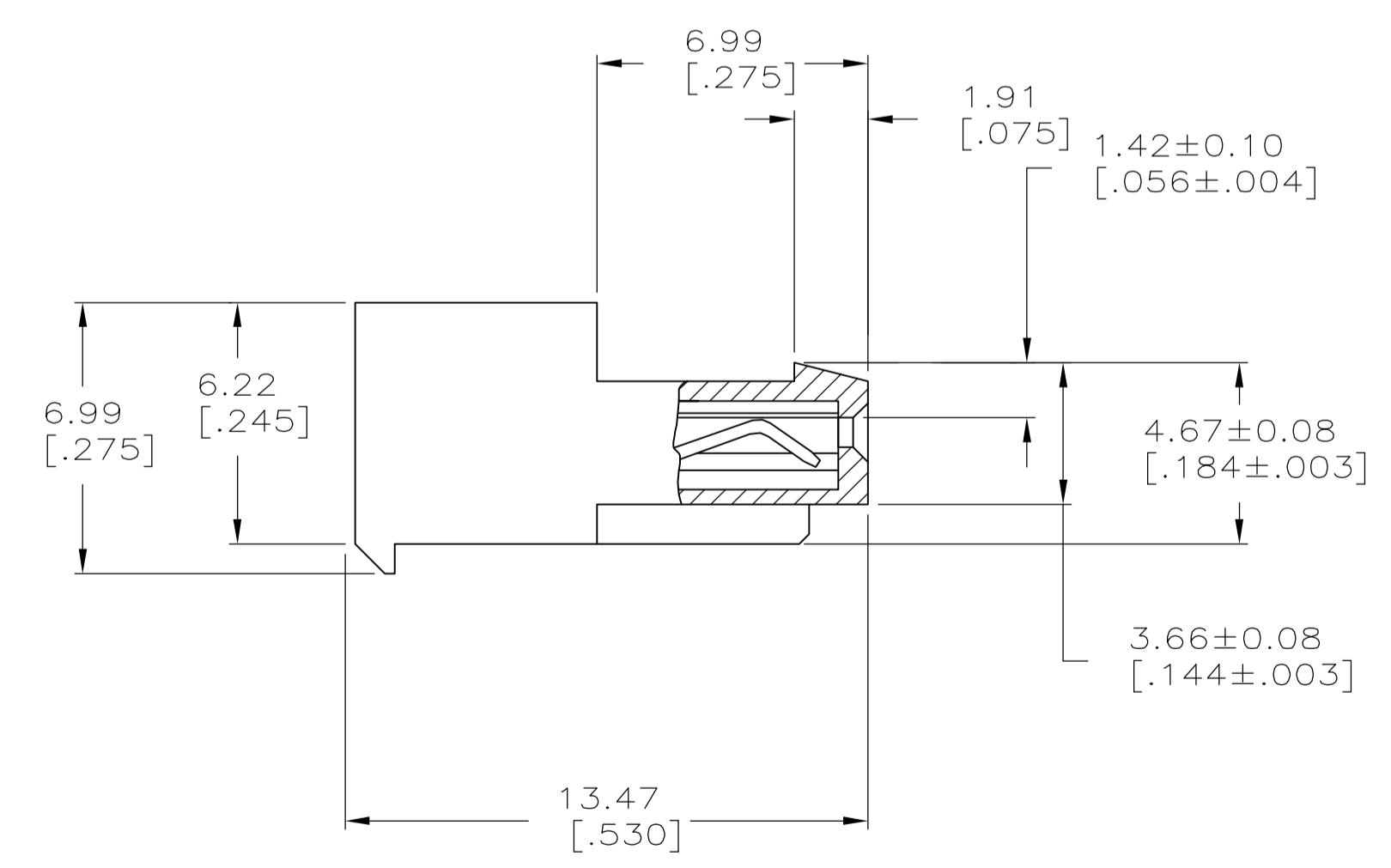
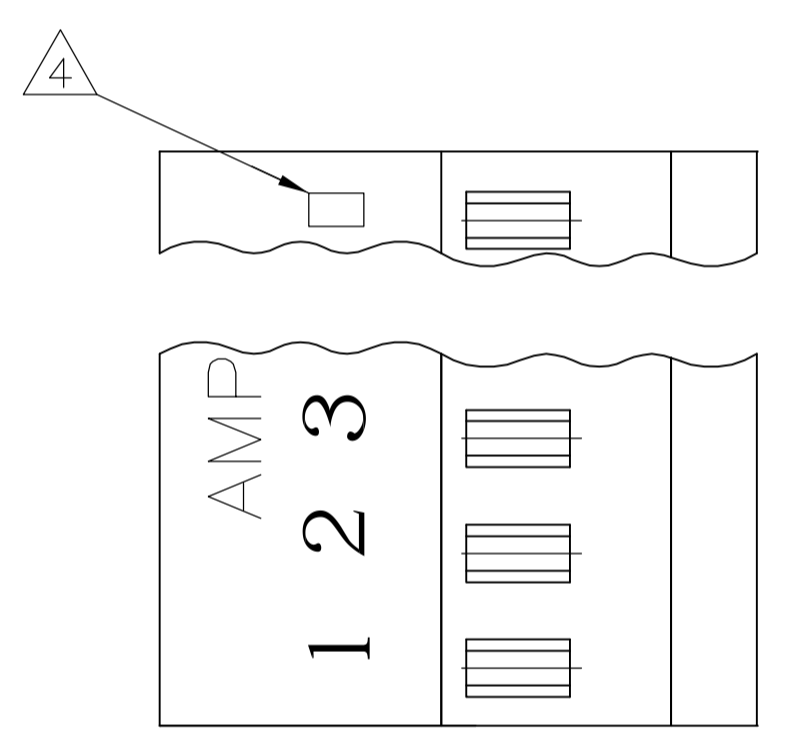

LEAD FREE			
	7.62 [.300]	3	3-641537-3
	5.08 [.200]	2	3-641537-2
	DIM A	NO.OF POSN	ASSEMBLY

CONTAINS LEAD			
	7.62 [.300]	3	641537-3
	5.08 [.200]	2	641537-2
	DIM A	NO.OF POSN	ASSEMBLY

# METRIC

THIS DRAWING IS A CONTROLLED DOCUMENT.

DIMENSIONS: mm [NCHES]	TOLERANCES UNLESS OTHERWISE SPECIFIED: 0. PLC ± 1. PLC ± 2. PLC ± 0.13 [.005] 3. PLC ± 4. PLC ± ANGLES ±	FINISH 1	DWN S. HOOVER 10-DEC-2004 CHK D. BOSSI 10-DEC-2004 APVD D. BOSSI 10-DEC-2004	NAME MTA-100 CONNECTOR ASSEMBLY, 28 AWG, FOR .014 TO .020 POST, SPECIAL
			PRODUCT SPEC 108-1050	RESTRICTED TO
			APPLICATION SPEC 114-1019	SIZE CAGE CODE DRAWING NO A1 00779 C=641537
MATERIAL 1			WEIGHT CUSTOMER DRAWING	SCALE 5:1 SHEET 1 OF 1 REV D